



# H<sub>2</sub> Pressure Regulator

Fuel Cells - ICE Conversions - Dual Fuel

# 703 Series

**703 Series:** Designed to be simple and lightweight, H2 technology's 703 series Hydrogen Pressure regulator offers a compact and durable device that will provide a stable outlet pressure.

Fully certified to EC79, the 703 series is currently in service in a wide range of applications, including: *Fuel cell applications, ICE Conversions, Dual fuel systems.*

Currently in service on a variety of vehicles, including: *Cars, Buses, light commercial vehicles, boats, and off highway equipment such as excavators, tractors and generator sets.*

The 703 series pressure regulator was designed without integral filtration, gauge ports or outlet pressure adjustment. The aim is to keep the regulator economical, and as simple and as possible, allowing it to be mounted easily, including within the tank.

With a proven performance in a wide range of applications, the 703 series Hydrogen pressure regulator offers a solution to many H2 fuel system applications.

Please contact our sales office for more information.

## Features & Benefits

875 Bar Max working pressure

EC79 Certified

Easy to mount

Stable Outlet Pressure

Reliable

Full UK Patent

Specification	703-3...	703-4...
<b>Max Inlet Pressure</b>	875 Bar	875 Bar
<b>Outlet Pressure Range</b>	0 — 20 Bar	0—60 Bar
<b>Max Flow Rate</b>	9.0 Kg/h	0—60 Kg/h
<b>Materials of Construction</b>	Stainless Steel 316L	
<b>Design Proof Pressure</b>	1400 Bar	
<b>Seat Leakage</b>	EC79 (Meets ANSI/FCI 70-3)	
<b>Weight</b>	550 grammes	1450 grammes
<b>Size</b>	Ø 30 x 130 Long	Ø42 x 165 Long
<b>Porting</b>	1/4" BSP 9/16" SAE	1/4" NPT custom configurations

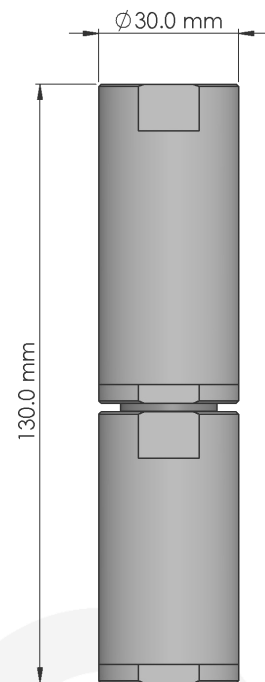

703-3 Configuration

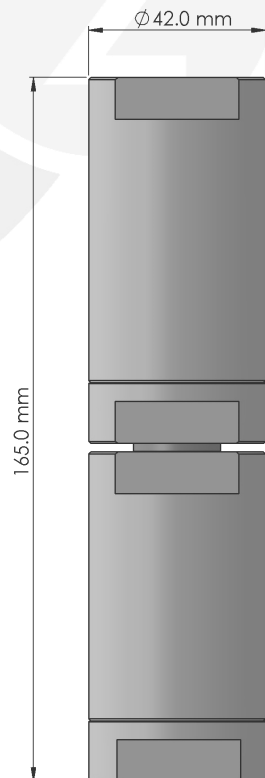

703-4 Configuration

UK Patent no. 4030258



# H<sub>2</sub> Pressure Regulator

Fuel Cells - ICE Conversions - Dual Fuel

703-4 Configuration flow characteristics available, please contact our sales office

**Part Number Generator**

**703 — X 0 0 X — XX**

Configuration	
<b>3</b>	Standard Flow (0—9 Kg/h)
<b>4</b>	High Flow (0—60 Kg/h)

Porting	
<b>0</b>	1/4" BSP
<b>1</b>	1/4" NPT
<b>2</b>	9/16" - J1926-1 SAE

Outlet Pressure set point	
<b>15</b>	0.15 MPa (1.5 bar)
<b>30</b>	0.30 MPa (3 bar)
<b>70</b>	0.70 MPa (7 bar)
<b>200</b>	2.0 MPa (20 bar)

Custom configurations and porting available, please contact our sales office or visit our website for details.

Regular service schedule recommended.

Example part number: 703-3000-70 Standard flow configuration, 1/4" BSP Inlet & outlet ports, 7 bar factory set outlet pressure

All of our products are constantly assessed for possible improvements and the specifications here are subject to change without notice.